

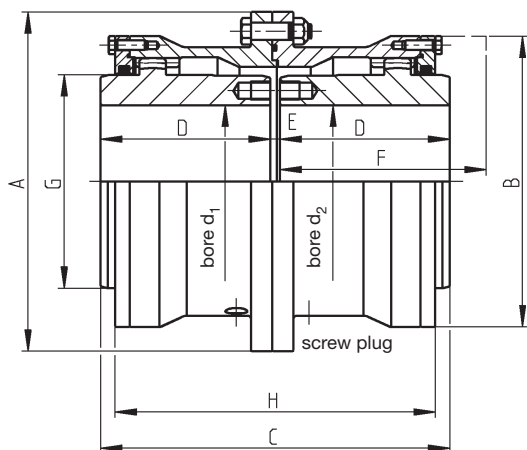

# Curved Tooth Couplings

## Construction Series SBk

Dimension Table No. 243 126/1 Page 2



Hub configuration II

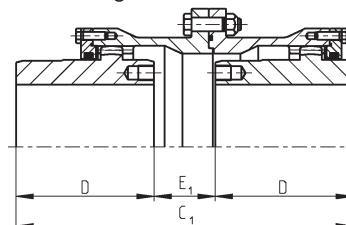

Hub configuration III

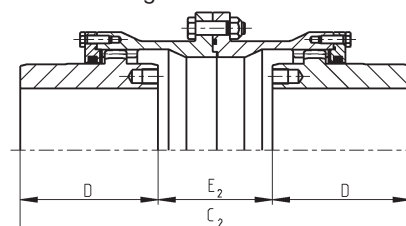

For coupling selection, please see size determination.

The dismounting dimension F is required to allow vertical installation and removal of the machines and O-ring replacement.

For torsional stiffness values, please see the data tables for SBk-type couplings.

1) Based on a permissible angular misalignment of  $\Delta K_{w \text{ perm}} = 0.75^\circ$  per coupling half.

2) Values for the complete coupling with bore  $d_1; d_2 \text{ max.}$

3) The maximum speed capacity depends on the misalignment. Please see table 'Speed Factors'.

Higher misalignment capacity is possible, but requires special measures.

**Other sizes available on request.**

Type SBk	Norm. Speed <sup>3)</sup> cont. duty		Dimensions														Max. static <sup>1)</sup> radial misalign- ment $\Delta K_{\text{max.}}$	Total grease quantity	Mass <sup>2)</sup> moment of inertia J	Weight <sup>2)</sup>
	$\frac{P_{KN}}{n}$ kW·min	$n_{\text{max.}}$ rpm	bore $d_1; d_2$		A	B	C	$C_1$	$C_2$	D	E	$E_1$	$E_2$	F	G	H				
475	184.8	850	395	550	1120	970	1030	1215	1400	500	30	215	400	580	770	930	±6	34	529	3435
500	220.8	825	420	570	1160	990	1090	1254	1418	530	30	194	358	610	800	950	±6	37	604	3730
530	247.2	800	450	605	1210	1060	1150	1282	1414	560	30	162	294	640	850	958	±6.5	45	789	4436
560	276.0	770	470	635	1250	1080	1220	1381	1542	590	40	201	362	670	890	1034	±6.5	47	927	4858
600	345.6	725	510	685	1340	1200	1280	1372	1470	620	40	132	230	710	960	1034	±6.5	50	1371	6035
630	393.6	700	540	715	1390	1240	1340	1410	1480	650	40	110	180	750	1005	1050	±6.5	59	1639	6815
670	523.2	650	580	785	1490	1360	1400	1430	1460	680	40	70	100	790	1100	1060	±6.5	64	2364	8290
710	616.8	625	610	815	1550	1385	1470	1470	1470	710	50	50	50	820	1140	1060	±6	66	2749	8883
750	688.8	600	650	870	1660	1510	1550	1550	1550	750	50	50	50	860	1220	1060	±6	68	3798	10832
800	775.2	575	700	905	1710	1545	1650	1650	1650	800	50	50	50	910	1270	1060	±6	84	4223	12094
830	873.6	550	730	950	1760	1620	1710	1710	1710	830	50	50	50	940	1330	1060	±6	105	5403	13484

Subject to change due to technical improvement.