

Curved Tooth Couplings

Construction Series SBR

Dimension Table No. 243 127

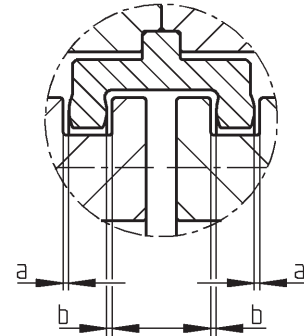
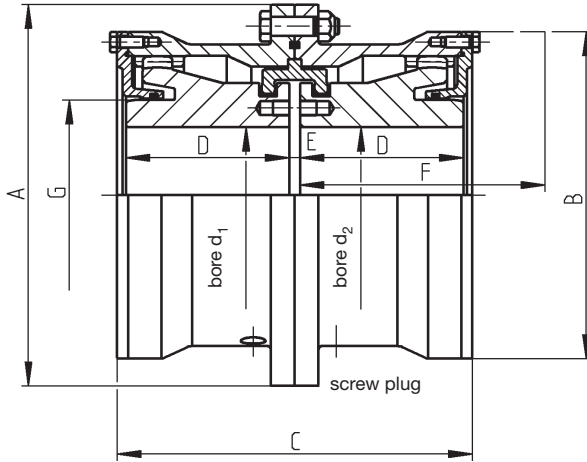

The construction series SBR is equipped with an U-shaped retaining ring for end float limitation. For these types, the permissible angular misalignment depends on the axial clearances a and b.

The maximum static parallel misalignment is to be calculated from the values of the comparable SB-types with the factor 0.4.

Sizes 30 to 200 available from stock. Other sizes available on request.

The dismantling dimension F is required for the vertical installation and removal of the machines as well as for mounting the retaining ring and the O-rings.

For torsional stiffness values, please see the data tables for SB-type couplings.

1) The permissible angular misalignment $\Delta K_{w \text{ perm.}}$ is 0.6° per coupling half, based on the values stated in the

list. The axial clearances a and b can be varied if the operation conditions require so.

2) Values for the complete coupling with bore $d_1; d_2 \text{ max.}$

3) The maximum speed capacity depends on the misalignment. Please see table 'Speed Factors'.

For coupling selection, please see page 6.

Typ SBR Size	Norm. cont. duty $\frac{P_{KN}}{n}$ kW·min	Speed ³⁾ $n_{max.}$ rpm	Dimensions										Axial clearances ¹⁾ a and b mm	Total grease quantity kg	Total oil quantity litres	Mass ²⁾ moment of inertia J kgm ²	Weight ²⁾ kg	
			bore $d_1; d_2$			A	B	C	D	E	F	G						
			pre mm	min mm	max mm	mm	mm	mm	mm	mm	mm	mm	mm					
30	0.082	7500	10	12	32	118	92	110	50	5	75	45	0.5	0.08	0.08	0.006	4.7	
40	0.146	6900	20	22	46	145	115	131	60	5	90	60	0.5	0.16	0.16	0.017	7.8	
50	0.288	6300	20	22	58	165	135	151	70	5	110	75	0.5	0.26	0.26	0.035	12.0	
60	0.50	5900	26	28	70	200	160	175	80	6	120	90	0.5	0.43	0.43	0.085	19.4	
70	0.82	5400	26	28	78	220	178	197	90	6	130	100	0.5	0.57	0.57	0.14	27.3	
80	1.14	5000	30	32	92	240	196	217	100	6	150	120	0.5	0.74	0.74	0.21	33	
90	1.64	4700	30	32	100	270	225	241	110	8	170	130	0.5	1.2	1.2	0.40	50	
100	2.30	4300	53	55	110	280	240	261	120	8	180	140	1.0	1.4	1.4	0.52	57	
110	2.88	4000	63	65	120	310	265	282	130	8	190	155	1.0	1.8	1.8	0.83	74	
125	4.60	3700	73	75	138	340	295	325	150	10	215	175	1.0	2.4	2.4	1.41	105	
140	6.48	3400	83	85	156	390	325	355	165	10	230	200	1.0	3.1	3.1	2.45	148	
160	9.24	3100	118	120	180	435	370	410	190	12	270	230	1.0	4.5	4.5	4.51	209	
180	12.92	2900	138	140	200	480	415	462	220	12	300	260	1.0	7.0	7.0	7.8	297	
200	18.4	2700	158	160	225	545	465	519	245	14	340	290	1.0	10.7	10.7	14.6	428	
220	25.6	2400	158	160	250	580	510	556	270	16	360	355	1.5	11.5	11.5	21.7	540	
240	32.8	2200	178	180	275	645	560	598	290	18	380	390	1.5	12.5	12.5	32.5	682	
260	41.0	2100	198	200	295	680	595	640	310	20	400	415	1.5	14	14	44.3	832	
280	51.4	2000	218	220	325	745	660	702	340	22	440	460	1.5	17	17	73	1130	
300	64.8	1900	238	240	340	775	675	744	360	24	470	480	1.5	20	20	88	1275	
320	82.0	1800	258	260	375	825	725	786	380	26	500	525	1.5	24	24	124	1535	
340	98.6	1700	278	280	400	915	795	808	390	28	520	560	1.5	28	28	185	1900	

Subject to change due to technical improvement.