

# Curved Tooth Couplings SBLk with HYGUARD® Safety Coupling BWL

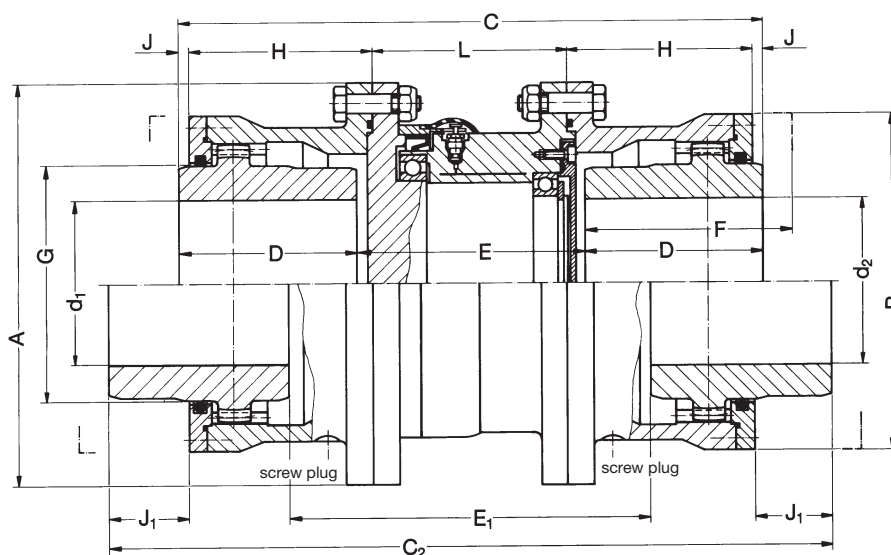

Table of Dimensions No. 243 089



The HYGUARD® Safety coupling BWL in flanged design is combined with a curved tooth coupling SBLk. The coupling dimensions and double engagement feature are the same as for the normal spacer coupling. In comparison with the SBL version, this combination has a lower permissible angular offset

amounting to a maximum of  $\pm 0.75$  degrees per coupling half or, when using special versions, up to  $\pm 2$  degrees. The housing is tooth tip and flank centered. Curved tooth couplings of the SBLk series are designed for grease lubrication. Couplings already in use can easily be retrofitted with the BWL safety coupling.

1) Values for complete coupling with max.  $d_1$  and  $d_2$

Dimensions are subject to change due to technical progress.

Type Combination SBLk/BWL Size	Torque Range T ~ Nm	Bore $d_1, d_2$			Dimensions													Weight <sup>1)</sup> kg	Mass Moment of Inertia <sup>1)</sup> J kgm <sup>2</sup>
		rough mm	min mm	max mm	A mm	B mm	C mm	C <sub>2</sub> mm	D mm	E mm	E <sub>1</sub> mm	F mm	G mm	H mm	J mm	J <sub>1</sub> mm	L mm		
38/ 30	400 – 800	10	12	42	118	92	207	231	60	87	111	90	60	58,5	5	17	80	10,6	0,0163
48/ 40	710 – 1420	20	22	55	145	115	244	286	70	104	146	100	77	72	5	26	90	19,2	0,045
60/ 50	1400 – 2800	20	22	65	165	135	285	339	80	125	179	110	90	82	5,5	32,5	110	28,2	0,085
70/ 60	2500 – 5000	26	28	80	200	160	302	374	90	122	194	120	112,5	94,5	4	40	105	44	0,185
80/ 70	4000 – 8000	26	28	92	220	178	328	412	100	128	212	130	128,5	105	4	46	110	56	0,295
90/ 80	5600 – 11200	30	32	105	240	196	360	456	110	140	236	140	145	115	5	53	120	72	0,453
100/ 90	8000 – 16000	30	32	115	270	225	404	506	125	154	256	150	160,5	130	7	58	130	103	0,843
110/100	11200 – 22400	53	55	126	280	240	444	552	140	164	272	170	176	140	12	66	140	121	1,07
125/110	14000 – 28000	63	65	145	310	265	476	592	150	176	292	180	200,5	150	13	71	150	158	1,73
140/125	22400 – 44800	73	75	162	340	295	530	670	170	190	330	200	224,5	175	10	80	160	213	3,02
160/140	31500 – 63000	83	85	185	390	325	582	726	190	202	346	230	256,5	190	16	88	170	295	4,96
180/160	45000 – 90000	118	120	210	435	370	654	830	220	214	390	260	288,5	219	18	106	180	407	8,82
200/180	63000 – 126000	138	140	230	480	415	731	935	250	231	435	300	320,5	249	19	121	195	550	14,46
225/200	90000 – 180000	158	160	260	545	465	812	1036	280	252	476	330	362	279	22	134	210	772	25,74
250/220	125000 – 250000	158	160	280	580	510	1122	1122	300	522	522	350	400	282	164	164	230	942	35,01